

THINK WEINIG

Machines and systems
for solid wood and
panel processing

Welcome
to HOLZ-HANDWERK 2016
in Nuremberg

16 to 19 March 2016

NEW 10:00 - 19:00

Saturday until 17:00

Hall 9, Stand 304 / 308



WEINIG



HOLZHER

Welcome

to the WEINIG Group at the trade fair in Nuremberg.

Modern production technology is more and more capable - but also more and more complex. Simple process handling is, therefore, a prerequisite for efficiency. That is why we will be presenting perfect solutions for solid wood and panel processing to you in Nuremberg that share an emphasis on intelligent production, integrated machine concepts and innovative operating systems. In addition, we will be exhibiting innovations offering performance levels in the entry segment that even until recently were reserved for high-end machines. Every reason, then, to THINK WEINIG and pay us a visit. Whether your requirements are in planing and profiling, cutting, window production or panel production.

We wish you a pleasant journey and an enlightening visit to our stand.

Yours



Gregor Baumbusch
Chief Sales and Marketing Officer

The WEINIG Group: Machines and systems for solid wood and panel processing

Innovative state-of-the-art technology, comprehensive services and system solutions through to turnkey production lines: the WEINIG Group is your partner for profitable processing of solid wood and panels.

SOLID WOOD



Planing, profiling,
tools, sharpening

Cutting, scanning,
optimization, gluing

Windows, doors,
CNC technology

Finger jointing,
jointing technology,
end profiling

PANELS



Edge banding

CNC processing

Vertical and
horizontal
cutting solutions

Automatic
panel handling

Resource management



Anybody who makes an income from wood has made a sound, future-proof choice. As a sustainable material, wood is without any real alternative in our world where there is an increasing emphasis on efficiency of resources. With its good static performance and individual appearance, solid wood is an increasingly popular construction material, both for interior fittings and exterior uses. As a technology leader, WEINIG

Wood is a winner



is helping to drive this trend. WEINIG machines and systems achieve optimal timber yields with ever-decreasing energy consumption, ensuring cost-effective production for our customers and the protection of resources. Furthermore, our customers benefit from synergies within the Group between members with solid wood expertise and panel processing specialist HOLZ-HER.

Messe Nürnberg Overview

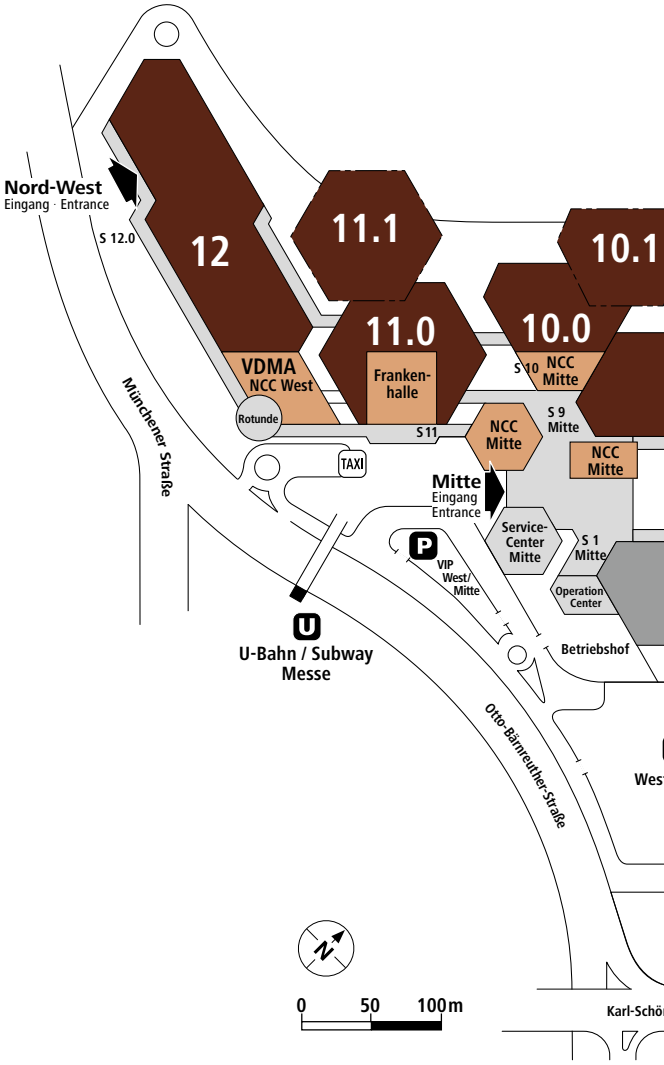

- FENSTERBAU FRONTALE
- HOLZ-HANDWERK

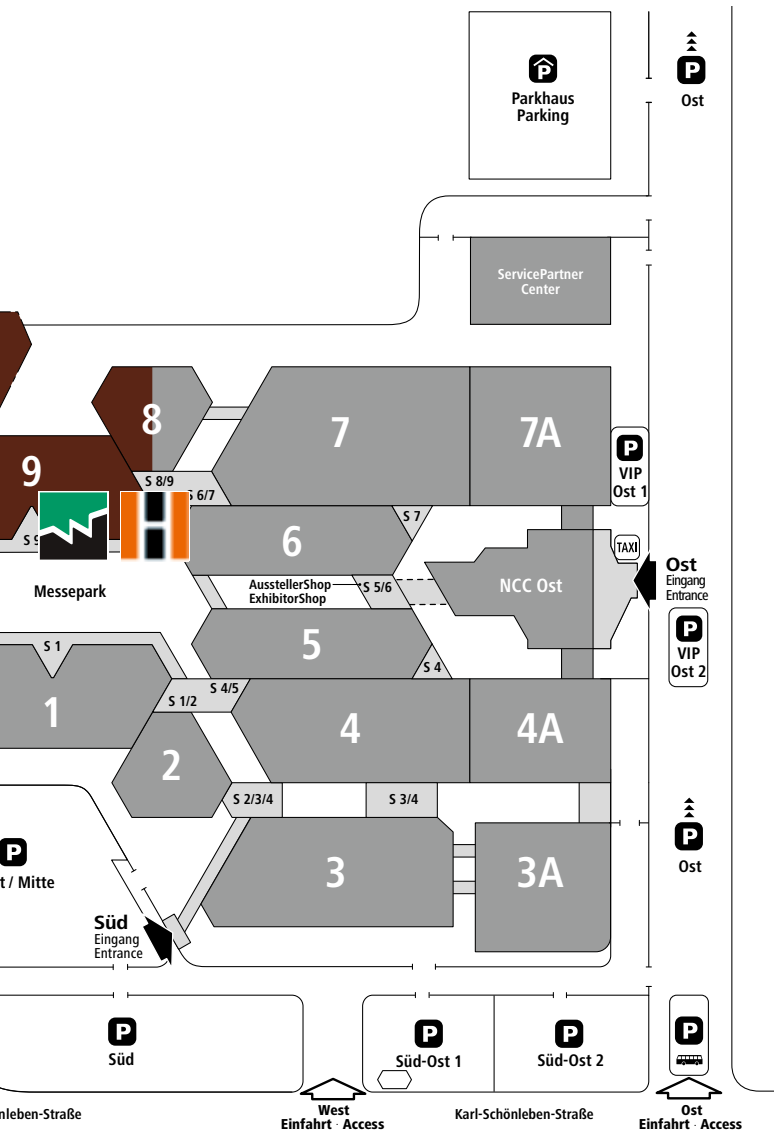

WEINIG



HOLZ-HER

WEINIG stand, Hall 9

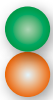

Solid wood processing

Panel processing

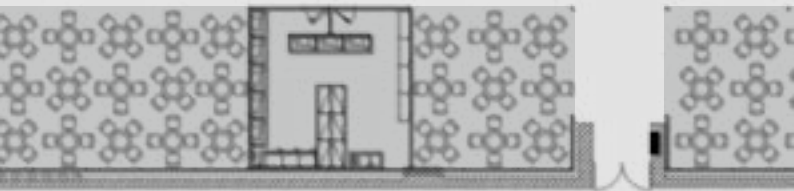
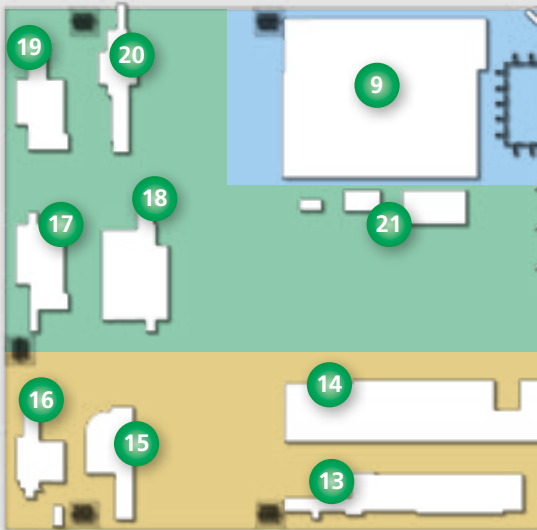
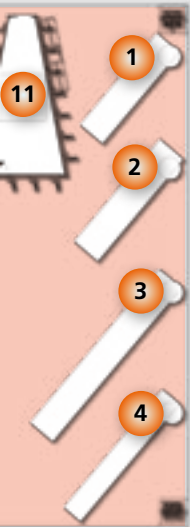

Windows/CNC
Profiling

Panel Processing
Cutting/Gluing



Services

Exhibits

- 1 WEINIG Services
- 2 WEINIG information
- 3 Conturex Compact
- 4 UniPin
- 5 Conturex Vario components
- 6 Wood/aluminum exhibits
- 7 Windows info stand with window element
- 8 Powermat 700
- 9 Multirex
- 10 OptiCut S 50
- 11 Cutting / Jointing Technology info
- 12 BKS
- 13 FlexiRip / FlexiCut
- 14 OptiCut S 60
- 15 UniRip
- 16 VarioRip 310 M
- 17 Powermat 700 / EM 100
- 18 Powermat 1500
- 19 Powermat 700
- 20 Cube
- 21 Rondamat 1000 / Moulder Master / OptiControl digital
- 22 Sample wall
- 1 Streamer 1057
- 2 Auriga 1308 XL
- 3 Accura 1558
- 4 Sprint 1329
- 5 Lumina 1586
- 6 Tectra 6120
- 7 StoreMaster 5110
- 8 ProMaster 7018
- 9 ProMaster 7125
- 10 Lumina 1380
- 11 HOLZ-HER zero joint world
- 12 Evolution 7402
- 13 Evolution 7405
- 14 Software
- 15 Cut 1255
- 16 Streamer 1054
- 17 HOLZ-HER information

WEINIG app with added value



Another app? Yes, but this one has multiple benefits. The WEINIG Service app offers a number of intelligent functions for woodworking professionals to help in their day-to-day work. These include angle calculations or remaining length calculations for edge banding.

For the WEINIG customer, the app also offers the benefit of perfect connection to the WEINIG world and all of its services. The WEINIG Service app can be downloaded free of charge from the App Store or the Google Play Store. Then all you need to do is register with WEINIG.

Trade fair info

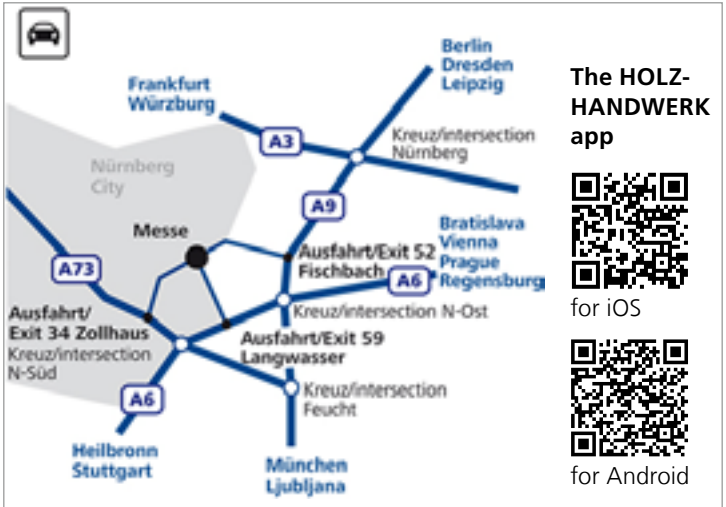

Event location

Messezentrum, 90471 Nuremberg, Germany
www.holz-handwerk.de/en

Directions

www.holz-handwerk.de/en/exhibition-info/travel

Address for satnav

Karl-Schönleben-Straße, 90471 Nuremberg or point of interest
'Messe' (exhibition center)

Opening times

NEW 10:00 - 19:00, Saturday until 17:00

WEINIG trade fair stand

Hall 9, Stand 304 / 308

Daily (except Saturday) from 18:00, Happy Hour in the WEINIG Bistro

Tickets

www.holz-handwerk.de/en/visitors/tickets

**WEINIG
OFFERS
MORE**

**... is a promise
No ifs or buts**

When it comes to reliability,
value creation and consultan-
cy services. Everything from a
single source.



WEINIG



HOLZHER

MICHAEL WEINIG AG
Weinigstrasse 2/4
97941 Tauberbischofsheim
Germany

Telephone +49 9341 86-0
Fax +49 9341 7080
info@weinig.com
www.weinig.com